

NETWORK SOLUTION  
Technically Power



## DG-12F

- ◆ Using passive infrared thermal imaging technology.
- ◆ Infrared thermal imager + HD visible light camera + turntable mechanism.
- ◆ Horizontal and tilt dual-axis gyro mechanical image stabilization.
- ◆ Visible light supports optical fog penetration.
- ◆ Continuous 360° horizontal rotation, and -90°~+90° pitch rotation.
- ◆ The fastest speed is 400°/s.
- ◆ The steady-state accuracy is 0.1°.
- ◆ 200 preset positions.
- ◆ Support GB/T 28181, ONVIF protocol.
- ◆ All metal structure, anti-fog, water-proof and anti-salt fog.
- ◆ Protection level: IP66.
- ◆ Lightning protection level: GB/T17626.5-4 (National Fourth) standard.
- ◆ Support remote restart.
- ◆ The circuit board can be disassembled and assembled, which is convenient for troubleshooting and maintenance.
- ◆ Stainless steel handle, level gauge, easy to install and construct.



## Specification

## DG-12F

### Thermal imaging parameters

Detector type	Uncooled focal plane
Detector pixels	640X480, 384X288 (optional)
Pixel size	17μm/25μm
NETD	≤0.06°C@F1, 300K
Focal length	Fixed focus 37mm or 50mm (optional)
Frame rate	50Hz

### Visible light parameter

Image sensor	2 million; 1/1.8
Minimum illumination	Color: 0.0005 Lux @(F1.5,AGC ON); Black and white: 0.0001Lux @(F1.5,AGC ON)
Lens	37 times (6.5~240mm)
Aperture	F1.5-F4.8
Horizontal field of view	70.0-2.51 degrees (wide angle-telephoto)
Close-up distance	100mm-150mm (wide angle-telephoto)
Support, area exposure/focus, optical fog penetration, electronic image stabilization, 3D noise reduction, etc.	

### Parameters of photoelectric turntable

Horizontal range	0°~360°
Horizontal speed	0.05°~400°/s
Pitch range	-90°~90° rotation (no wiper), -60°~90° rotation (with wiper)
Vertical speed	0.05°~200°/s
Preset points	200

### Image stabilization function

Gyro stability	Dual axis
Steady state accuracy	0.1°
Maximum carrier following speed	100°/s

### System interface parameters

Network interface	1 RJ45 10M/100M adaptive Ethernet port
Network protocol	IPv4, HTTP, FTP, RTSP, DNS, NTP, RTP, TCP, UDP,
Communication protocol	ONVIF, GB/T 28181
Alarm input or output	1 way
External data interface	1*RS422

### System physical characteristics

Color/Material	Black, white; high-strength aluminum alloy die-casting shell, all-metal structure
Protection level	IP66
EMC	Lightning protection, anti-surge and anti-surge protection, in line with GB/T17626.5 6KV standard
Dimensions in mm	Diameter 326mm, height 446mm
Working temperature	-40°C~70°C
Weight	15kg slightly different for different modules
Power consumption	60W (normal work under normal temperature)
Power supply	DC24V ± 15%, 5A

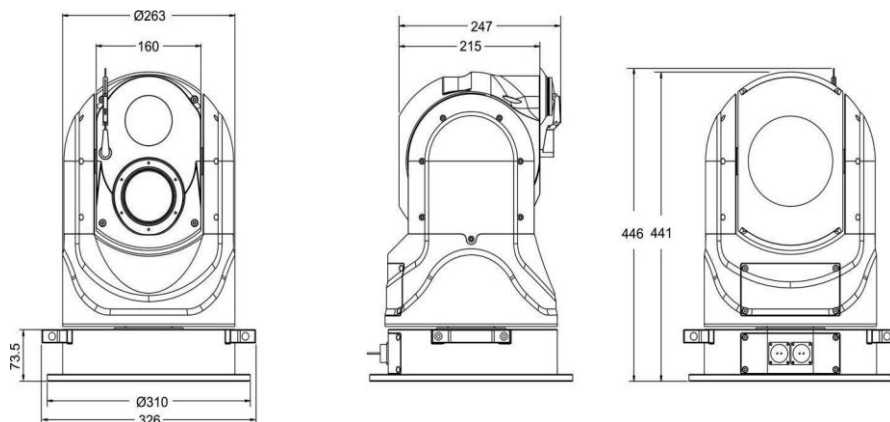

## Office Sales india 13 branches

Email: [info@digitronicssolution.com](mailto:info@digitronicssolution.com)

Website: [www.digitronicssolution.com](http://www.digitronicssolution.com)

Office: 301 Samad Arcade, Near Kausa Kabrastan, Kausa Mumbra-400612.

Office: +91 9768234946, +91 84528 71967, +91 70218 29855, +91 90048 61466.

